

U.S. PAPER COUNTERS' SHOOTER-III COUNTING / TAB INSERTING MACHINE TABLE OF CONTENTS

SECTION #1: LIMITED WARRANTY	3
SECTION #2: TECHNICAL DETAILS	4
SECTION #3: INSTALLATION	7
SHOOTER STAND ASSEMBLY	9
USING THE TAPE DEFLECTOR.....	11
LOADING INSERT TAPE	12
OPTIONAL 90DEG	13
SWIVEL MOUNT ASSEMBLY	14
SECTION #4: OPERATION	15
SHOOTER-III	15
SECTION #5: BASIC ADJUSTMENTS & MAINTENANCE	17
CHANGING TAPE CHUTE ASSEMBLY	17
ALIGNMENT OF LOADER BOX	17
CHANGING TAPE DRIVE BELT	18
MAINTENANCE.....	18
SECTION #6: PARTS LISTS	19
SECTION #7: PICK-UP CONNECTIONS	27
U.S. PAPER COUNTERS PARTS & SERVICE	30
INDEX.....	31

NOTE: U.S. Paper Counters reserves the right to change the price, appearance, specifications or design of its products at any time without notice or incurring the obligation either to modify units previously manufactured or to furnish products with previously published specifications.

SECTION #1: WARRANTY

U.S. Paper Counters - Shooter III Warranty

U.S. Paper Counters (USPC) warrants all of their counting machines and parts thereof to be free from any defect in material or workmanship and will replace any parts free of charge that may prove defective within one year from date of delivery of the machine concerned. The purchaser is responsible for all shipping costs associated with the return of defective parts and the dispatch of replacement parts.

USPC is not obligated to replace any machine in its entirety. All equipment is warranted to the original owner only.

If a machine that is still under warranty is returned to USPC for service or repair, the parts and factory labor for the work will be free of charge. Those parts that are considered maintenance consumable items such as filters and belts are not included under this warranty. The warranty is not valid for any parts that have been altered in any way, or which have been subject to misuse or accidental damage. We reserve the right to use reconditioned parts for warranty replacement. Repaired machines or replacement parts are warranted for the time remaining on the original warranty, 12 months from delivery of the original purchased equipment.

Using insert tape or parts other than that obtained by USPC may void your warranty.

USPC tracks warranty information by Serial Numbers. Use this number when calling concerning warranty issues.

Revised 11-08-23

SECTION No. 3: TECHNICAL DETAILS

SHOOTER III

SPECIFICATIONS:

- * Maximum Height w/Standard Pedestal - 54" (135cm)
- * Minimum Height w/Standard Pedestal – 38" (2.50cm)
Custom sizes are available upon request
- * Shooter Weight - 30 lbs (14kgs)
- * Shipping Weight - 36 lbs (17kgs) (Note: that dimensional weight associated with shipping dimensions may be higher than actual weight.)
- * Standard Electrical -110V AC

FEATURES:

- * Counting Speed – equal to your equipment
- * Tab Insertion - 5 Thru 9999
- * Total and Batch Count
- * High Speed Tab Insertion – Up to 3 tabs/sec
- * Subtract Count
- * Touch Panel Display with Total and Batch Count
- * Variable Tape Length Control
- * Variable Knife Cut Delay
- * CustomTape Chute Lengths (16" Standard (40cm)) chutes can be made from 8" – 36" (additional fee applies.)
- * Electronic Coupling Pick-Up (universal connection), Dry Contact or Optical sensor

OPTIONS:

- * 90 Degree Chute
- * Laser Sensor
- * 220V AC Power Supply
- * Custom Pole Extensions Available so that Shooter III works with your eqpt.

Standards of Conformity

CE: Standards to which conformity is declared:

2006/42/EC

Machinery Directive -Safety

Tech Directive: EN 60204-1
89/336/33C EMC Directive
Replaced by 2004/108/EC
Replaced by 2014/30/EU
Tech Directive: EN 61000-6-2

73/23/EEC Low Voltage Directive
Tech Directive: EN 60065

OSHA: All Models are in compliance with all US Government Standards as required by OSHA.

SECTION #3: INSTALLATION

SHOOTER III INSTALLATION Refer to Drawing TS-200-3-STD ASSY

1. Stand Assembly

The stand comes mostly preassembled with final assembly of just four parts.

- A. Start with the five-arm starfish shaped base. Separate the base plug into two pieces and sandwich it into the stand base center hub.
- B. Take the pole assembly and screw it down onto the 3/8" UNC threaded plug bolt and tighten the pole assembly and plug to the base.
- C. Tighten the pole clamp so that the telescoping pole does not slide.

2. Mounting the Shooter Head

- A. Mount the Shooter III Head to the Mounting Head Adaptor by removing the locking lever and spacer. Now thread them back into the adaptor through the mounting angle bracket on the bottom of the Shooter III Head. Now tighten the locking lever.
- B. To adjust the height of the Shooter III Head to the desired height and angle, loosen and adjust the pole clamp and locking lever. We recommend doing these adjustments with two persons doing each adjustment one at a time. One person holds the head in position and the second person loosens and then tightens the clamp and lever sequentially.
- C. Make final height and angle adjustments in the same manner when the Shooter III is positioned for operation.

3. Connecting Power and Count Signal cables

- A. Check that the power switch is in the off position. Separate the cord power J-cord from the Power supply. First plug in the power supply cable to the Shooter III Head. Now plug in the J-Cord to the power supply. Now plug the unit into your wall receptacle or lead cord. Position the power supply on the pole with velcro provided.
- B. To connect your Pick-Up cable, connect the pigtails to your equipment as directed by the manufacturer for either dry contact or voltage signal. Make sure that you have purchased the correct cable for your machine. If you have a voltage count signal from your equipment, be advised that USPC's Electronic Count Pick Up cable is wired for high voltage (50V to 120V) from the factory. If your signal is low voltage (8V to 50V), follow the instructions on the

cable control box to switch to low voltage. If your machine has a Dry Contact count signal you will need a different cable part which should have been ordered when purchasing the Shooter III. Again, connect the pigtail wires to the appropriate terminals as directed by the manufacturer of your equipment. If you have purchased a Laser Pick Up, mount the laser to your equipment to read a count signal every time a sheet drops onto the stack. After installing or wiring the count signal cable to your press, plug in the cable to the “input” plug of the Shooter III Head.

- C. Now you are ready to power up your equipment.

DRAWING TS-200-3-STD ASM

KEY	DESCRIPTION	PART NO.
1	Pole Plug	TS-207
2	Telescoping Pole -STD Assy	TS-200-3C-STD
3	Pole Clamp	TS-200-L
4	Base Pole -STD Assy	TS-200-3B-STD
5	Base Pole Insert	TS-200-3D-STD
6	Stand Adapter - Base Plug	TS-200-F
7	Stand Base Assy	TS-200-A
8	Head Mounting Adapter-3	TS-206-3
9	Spacer (A)	TS-202
10	5/16" Lock Washer (1)	H-296
11	Locking Lever Handle	TS-204-3
12	3/4-20 x 1 1/2" Bolt	H-100
	1/4-20 Star Washer	H-136
	3/4-20 Flat Washer	H-140

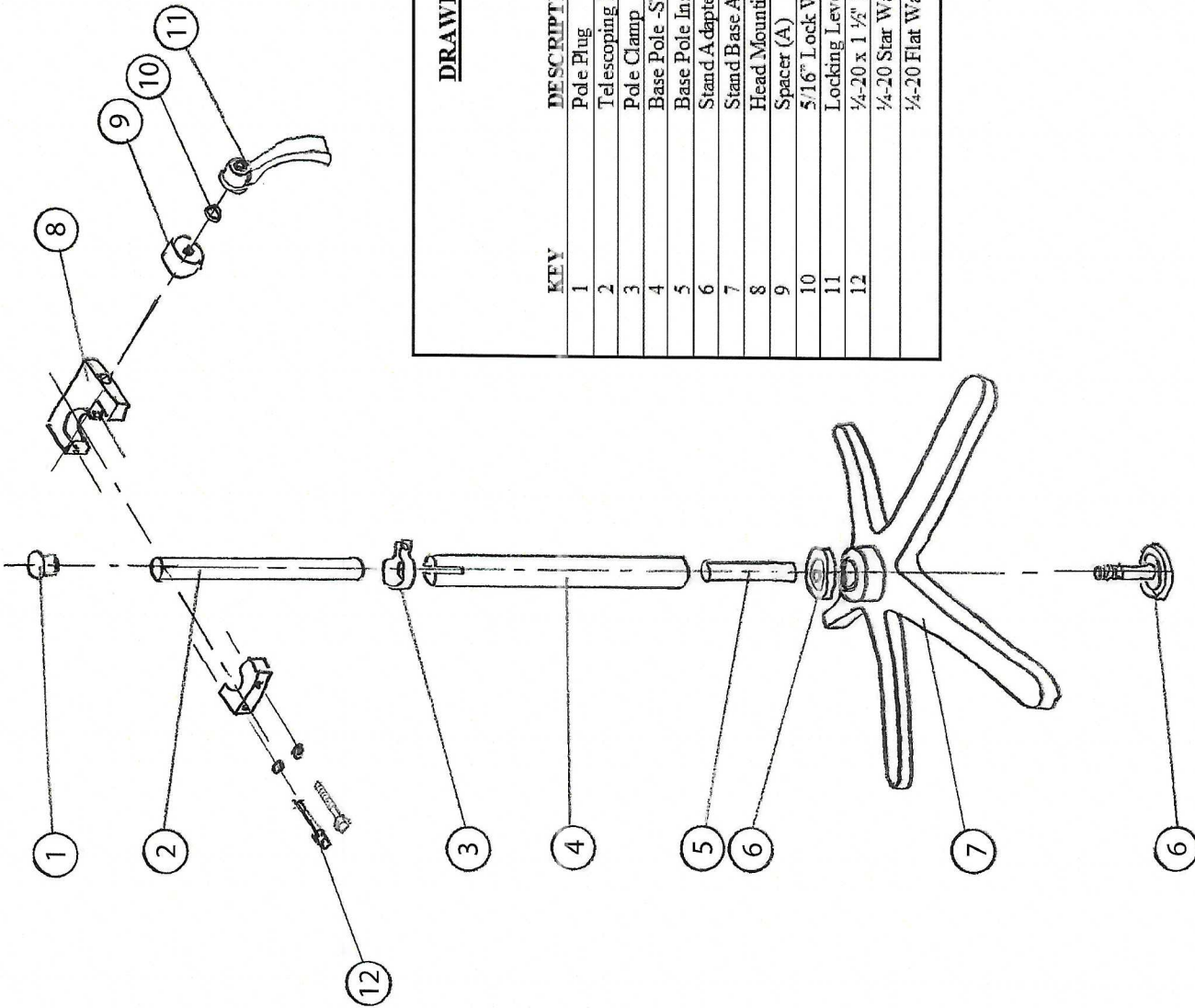

 <p>U.S. Paper Counters Paper Counting Specialists</p>	<p>TITLE</p> <h1>SHOOTER III STAND</h1> <h2>ASSEMBLY DRAWING</h2>		<p>SCALE</p> <p>NONE</p>	<p>DATE</p> <p>09-22-2023</p>
	<p>DRAWING NO.</p> <p>TS-200-III-2022</p>			

DRAWING TS-200-3-STD ASM

KEY	DESCRIPTION	PART NO.
1	Pole Plug	TS-207
2	Telescoping Pole -STD Assy	TS-200-3C-STD
3	Pole Clamp	TS-200-L
4	Base Pole -STD Assy	TS-200-3B-STD
5	Base Pole Insert	TS-200-3D-STD
6	Stand Adapter – Base Plug	TS-200-F
7	Stand Base Assy	TS-200-A
8	Head Mounting Adapter-3	TS-206-3
9	Spacer (A)	TS-202
10	5/16” Lock Washer (1)	H-296
11	Locking Lever Handle	TS-204-3
12	¼-20 x 1 ½" Bolt	H-100
	¼-20 Star Washer	H-136
	¼-20 Flat Washer	H-140

USING THE TAPE DEFLECTOR

Drawing #2

TAPE CHUTE LENGTHS

Standard: 16" (40cm)
Custom Sizes Available

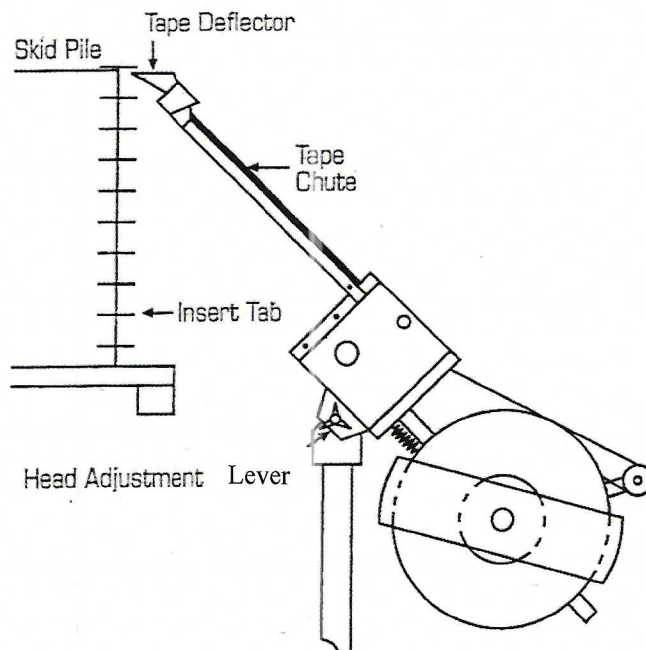

The Tape Deflector is used when the Shooter III Head is tilted at an angle for improved access to the pile. The deflector directs the tab into the stack so that it is parallel to the pile when the chute is angled as shown. With the tape deflector you can extend the reach from the maximum height of 54" by 12" or more depending on the chute length.

LOADING INSERT TAPE - DRAWING #3

INSERT TAPE (Tabbing Material): Standard rolls of 9" (22cm) in diameter by 1/2" (1.25cm). Tape rolls are placed over mounting hub and tape core is pressed firmly on pointed locating pin. Tape reel cover is positioned and held in place by wing nuts.

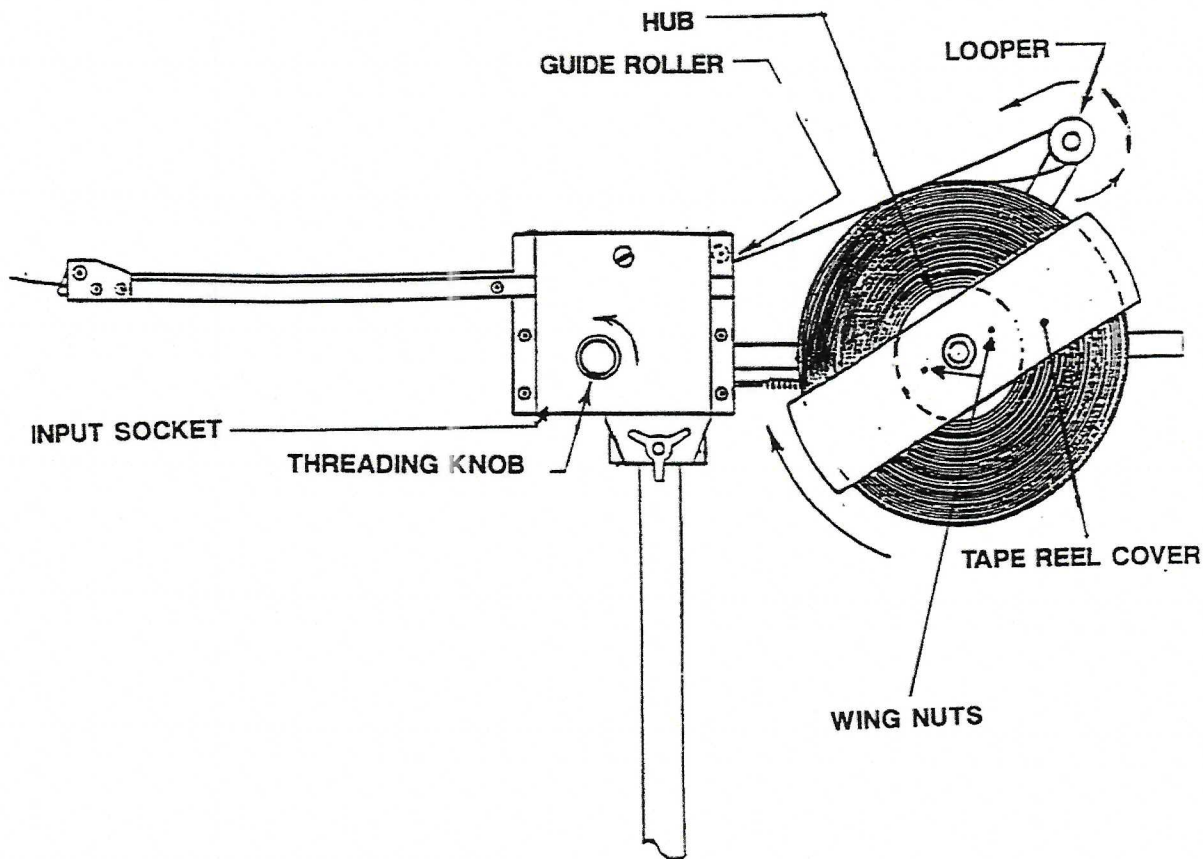

LOADING TAPE: Feed tape roll in a clockwise direction around looper and insert approximately 1-1/2" (3.75cm) into head below guide roller as shown. Then press the "Tape Feed" button until tape appears through the end of the chute. Press the "Knife Cut" button to cut off excess tape from end of chute.

OPTIONAL 90DEG -DRAWING # 4

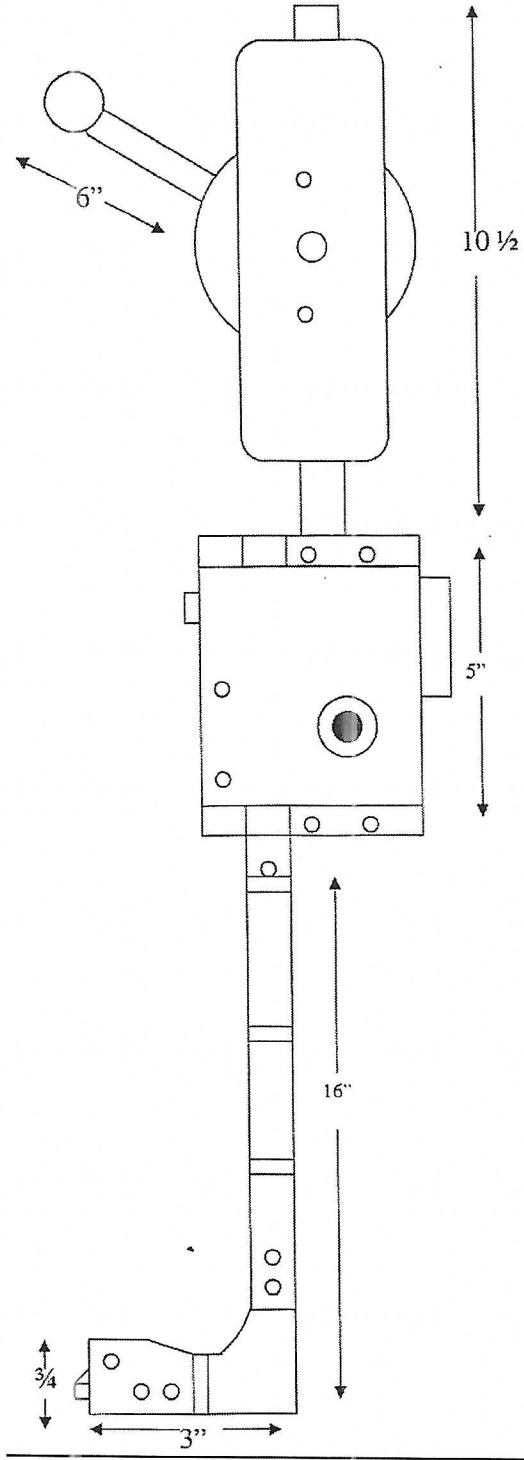

SWIVEL MOUNT ASSEMBLY – DRAWING #5

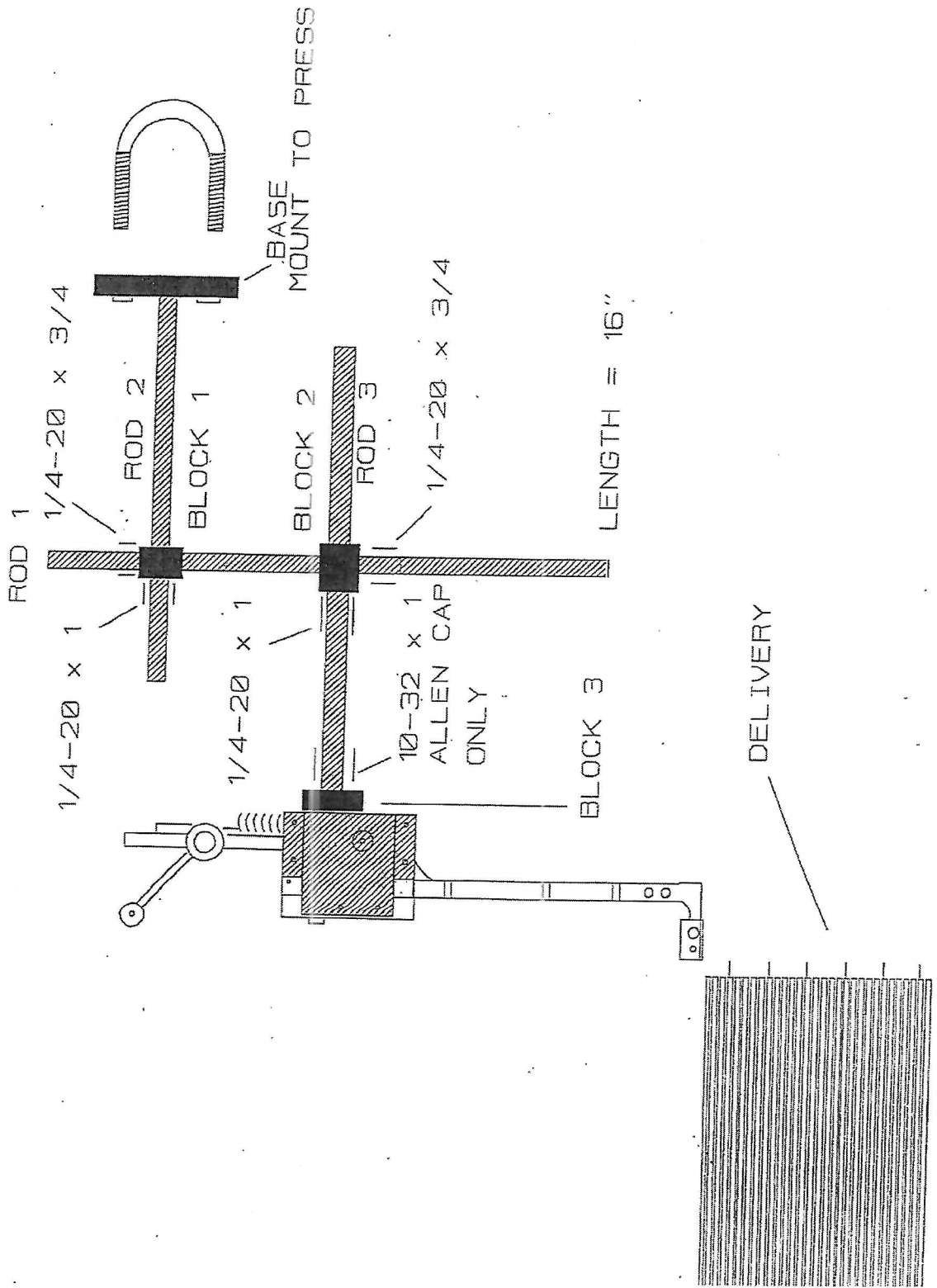

SECTION #4: OPERATION

OPERATION of the SHOOTER-III

1. Turn the Power On

Actuate the green power rocker switch. The switch should illuminate indicating the power is on. The operator touch screen will power up and the program will load automatically. The screen will stop at the Main Menu screen. If the touch screen is not on the “Main Menu”, press the Main Menu box to return to the Main Menu.

2. Setting Batch Size:

To set the batch size, press the “Batch Amount” box on the screen. When the “**Batch Amount**” is pressed, a keypad will appear. Using the keypad on the screen, enter the desired batch amount. (i.e. the number you want the stack to be separated: 10’s, 25’s, 50’s, etc.) Now press the “**Enter**” key to return to the “**Main Menu**”

3. Setting the Tape Length

The tab length is set by adjusting the time that the tape feed motor is on. The factory setting is “5”. This is a relative number. It generates a tab that is about 4” long. By lowering the Tape Length number to 4 the tab will be shorter. By raising the Tape Length number to 6 the length of the tape will be longer. Usually a tape length of 4” is recommended.

To set the tape length, press the “Settings” box on the Main Menu screen. Once at the Settings screen, press the tape length box and a keypad will appear. Type in the number you want and hit enter. The new tape length setting will take and the length will be changed.

4. Setting the “Knife Delay”

The Knife Delay setting is also a time delay. It represents the time the tab is held in place after insertion into the pile before the tab is cut. The intent is to allow additional sheets to land on top of the tab and hold it in place before it is cut.

To set the Knife Delay, press the “Settings” box on the Main Menu screen. Once at the Settings screen, press the Knife Delay box and a keypad will appear. Type in the number you want and hit enter. The new Knife Delay setting will take and the delay will be changed.

The Knife Delay number is also a relative number. The number of sheets that land on top of the tab before the knife cut actuates will depend on how fast your press or sheeter is operating. The factory setting is 25. Set the delay so that 2 or 3 sheets fall on top of the tab before it cuts. Lowering the number will decrease the time before cut and reduce the number of sheets that drop on top of the tab. Raising the number will increase the delay allowing more sheets to drop.

5. Setting the “Knife Pulse”

The Knife Pulse is the time that the Knife Cut Solenoid is actuated. The number needs to be long enough so that the knife cuts the tape completely.

To set the Knife Pulse, press the “Settings” box on the Main Menu screen. Once at the Settings screen, press the Knife Pulse box and a keypad will appear. Type in the number you want and hit enter. The new Knife Pulse setting will take and the delay will be changed.

The Knife Pulse number is the time in tenths of a second. The factory setting is 5 and probably should be left at that number. If you have an incomplete knife cut, it may be more of the sticky knife blade than too short of a pulse time.

6. Resetting the Total number of Sheets counted and the total number of “Batches Made” to “Zero”:

Press the “Reset Totals” box displayed on the Main Menu to zero out the total boxes.

7. Auto Tape Feed:

Press the “Tape Feed” box located on the bottom of the Main Screen. The tape will feed as long as you hold the box.

8. Auto Knife Cut:

Press the “Knife Cut” box located on the bottom right of the Main Screen. Touching this box will send a momentary signal to the knife but solenoid and cut the tape.

9. Subtract Sheet:

Press the “Subtract Sheets” box on the top of the Main Menu screen.

NOTE: will only subtract one sheet at a time.

SECTION #5: BASIC ADJUSTMENTS & MAINTENANCE

CHANGING TAPE CHUTE ASSEMBLY

**(Note: This is not recommended to do in the field. U.S. Paper Counters recommends that you send the tabbing head to them and have one of our trained service techs install the new chute.)
(Refer to drawing #7, page 28)**

1. Remove Tape Feed Knob and Loader Box Assembly.
2. Carefully remove Front and Back Covers.
3. Remove Knife Return Spring.
4. Remove Spring Clip from Knife Assembly. Slide off and remove Threaded Rod.
5. Remove Tape Chute Mounting Bolts from chassis and gently lift out old Tape Chute.
6. Replace new Tape Chute, adjusting so Tape Drive Belt protrudes .05" above Chute surface. Tighten screws securely.
7. Replace Knife Return Spring.
8. Replace Loader Box and Front Cover as described in this section.
9. Replace Tape Feed Knob and Back Cover.

ALIGNMENT OF LOADER BOX

(refer to drawing #7, page 28)

1. Place Loader Box and Front Cover in position and fasten Front Cover with 4 small allen screws. Screw in large Loader Box screw but do not tighten.
2. Adjust pressure of Loader Box against Tape Chute until tape moves freely through Chute, using Tape Feed Knob.
3. Tighten screw.

NOTE: If after securing Loader Box, Tape Feed Knob appears stiff and hard to manually turn, loosen pressure slightly between Loader Box and Tape Chute (with tape feed knob facing you adjust right side of loader box only, left side stays flush with tape chute). If Knob spins freely but tape seems to slip and does not move in a steady motion, increase pressure slightly between Loader Box and Tape Chute (right side only).

CHANGING TAPE DRIVE BELT

(refer to drawing #7, page 28)

1. Remove Tape Drive Knob and Loader Box Assembly.
2. Remove Front Cover.
3. Remove Shoulder Bolt holding large pulley. Remove pulley.
4. Place new belt on small pulley and replace large pulley with shoulder bolt. Tighten securely.
5. Replace Cover, Loader Box and Knob.

MAINTENANCE

1. As needed, remove Front and Back Covers and blow out any accumulated paper dust from Loader Box and surrounding area.
2. Blow out accumulated dust, powder, etc. from “**Knife assembly**”. (Note: **DO NOT LUBRICATE ASSEMBLY.**)
3. Check all screws, nuts, etc. to ascertain tightness.
4. Using a Q-tip and alcohol, or similar fluid, clean any ink build-up from the ink and punch rollers and roller shafts to allow free spinning.

SECTION #6:

DRAWINGS & PARTS LIST

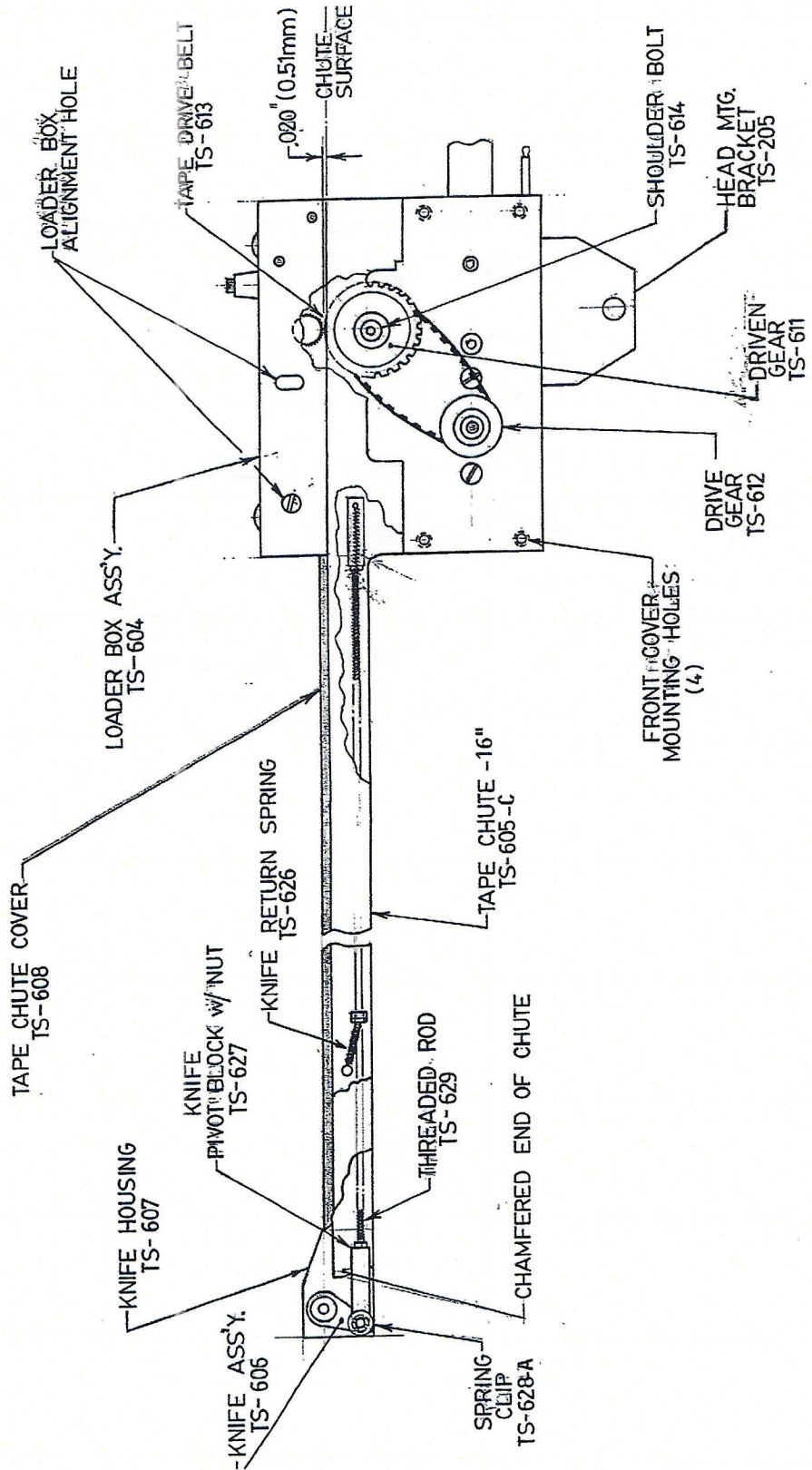

DRAWING NO. 7

TS-205	HEAD MOUNTING BRACKET
TS-602	REAR COVER
TS-604	LOADER ASSEMBLY
TS-605-C	TAPE CHUTE-16"
TS-606	KNIFE ASSEMBLY
TS-607	KNIFE HOUSING
TS-608-C	PLASTIC CHUTE COVER-16"
TS-611	DRIVEN GEAR
TS-612	DRIVE GEAR
TS-613	DRIVE BELT
TS-626 (revised S-6279)	KNIFE RETURN SPRING
TS-627	KIFE PIVOT BLOCK
TS-628-A	SPRING CLIP
TS-629-C	THREADED ROD-16"
TS-622 *See Drawing #9	TAPE REEL COVER ASSEMBLY

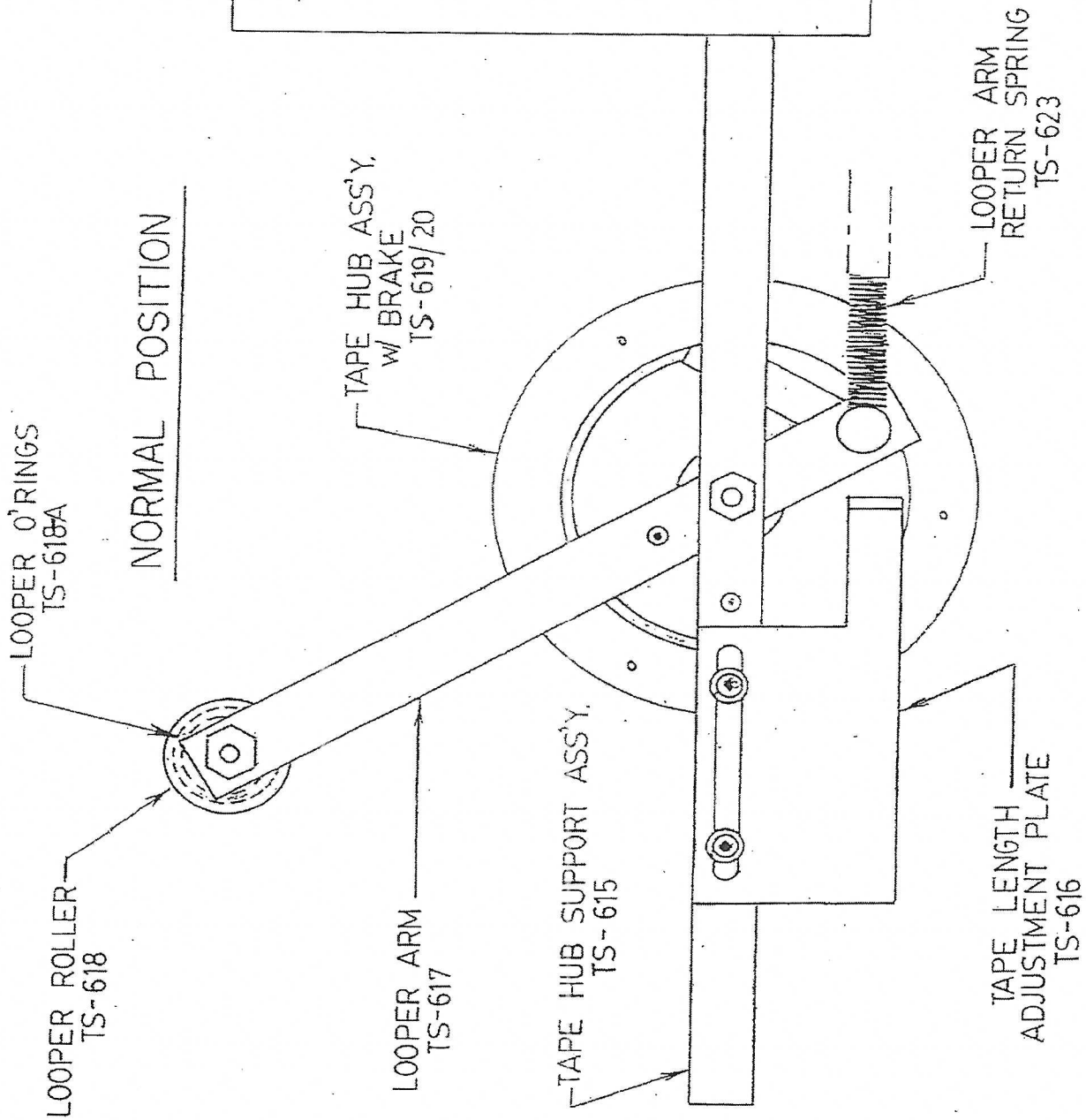

BRAKE HUB ASSEMBLY – DRAWING NO. 8

TS-615	TAPE HUB SUPPORT
TS-616	TAPE LENGTH ADJUSTMENT PLATE
TS-617	LOOPER ARM
TS-618	LOOPER ROLL
TS-618-A	O-RINGS (3 per unit)
TS-619	TAPE HUB ASSEMBLY
TS-620	BRAKE ASSEMBLY
TS-623	RETURN SPRING

Tabbing Head w/Deflector, Tape Reel Cover Assy.
Drawing # 9

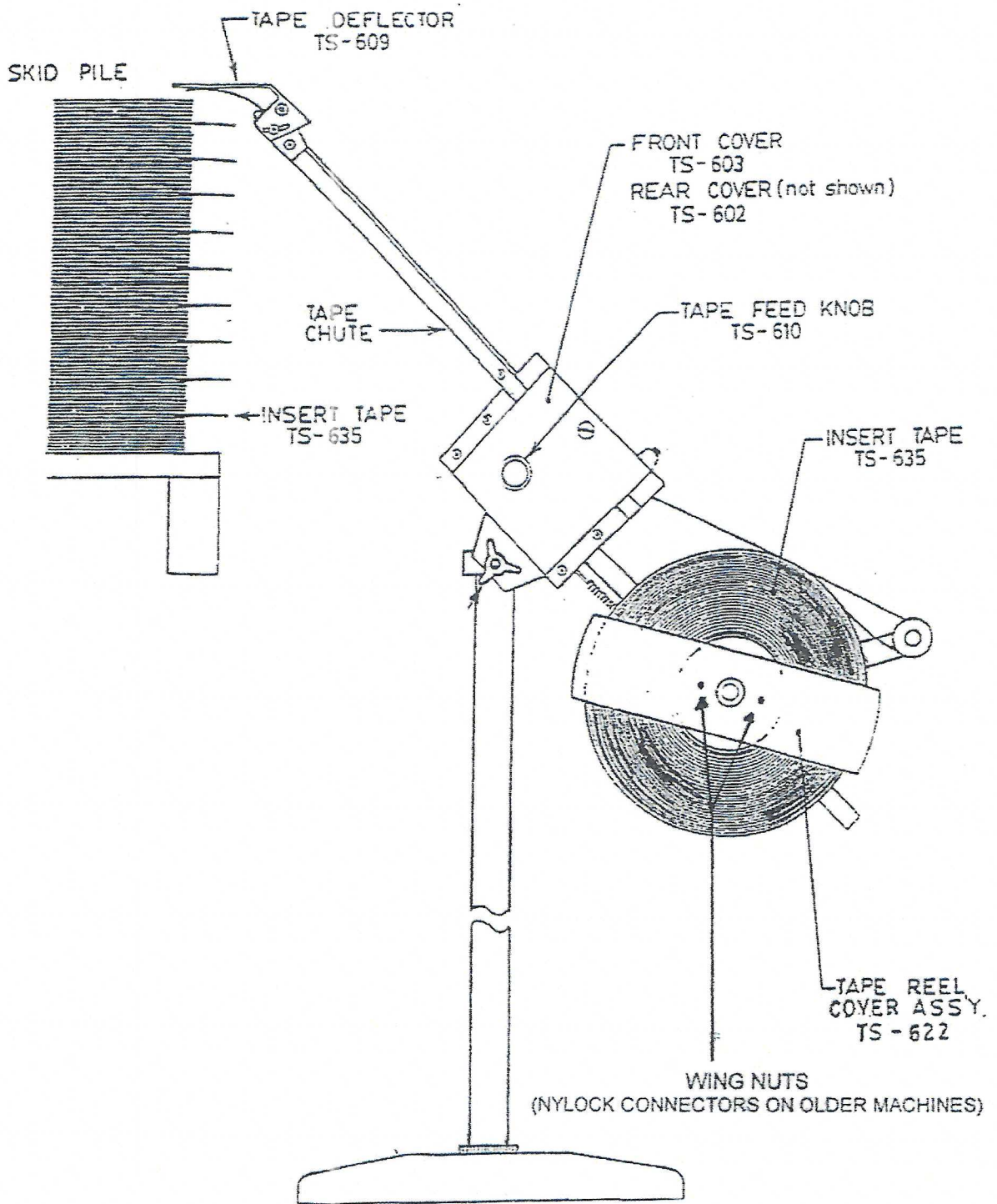

DRAWING NO. 9

TS-602	REAR COVER (Not shown)
TS-603	FRONT COVER
TS-609	TAPE DEFLECTOR (Optional)
TS-610	TAPE FEED KNOB
TS-622	TAPE REEL COVER ASSEMBLY
TS-622-E	¼- 20 WING NUTS (Older models may have NyLock Connectors)
TS-635	INSERT TAPE (20 rolls per case – call for pricing)



TS-300-C	DRIVE MOTOR
TS-301-R	ROTARY SOLENOID
S-3026	TWO CHANNEL RELAY BOARD
TS-110	GREEN ILLUM. ROCKER SWITCH
S-3003-F	SCREW STYLE FUSE ADAPTER
TS-146-X4R-611	PLC - X4R
TS-305	EURO POWER SOCKET
TS-106	6-PIN INPUT SIGNAL SOCKET



TITLE:

**SHOOTER III
INTERNAL COMPONENTS**

SCALE: NONE

DATE: 09-22-23

DRAWING NO. 10

SECTION #7: PICK-UP CONNECTION (DRY CONTACT & E.C. PICK-UP)

DRAWING #12 -DRY CONTACT - EC PICK-UP PRESS CONNECTION

Typical press connection using Dry Contact Pick Up

TS-311-1

TS-311-B: E.C. Pick up adaptor "AKA Pigtail"

Gets wired to an open / close connection

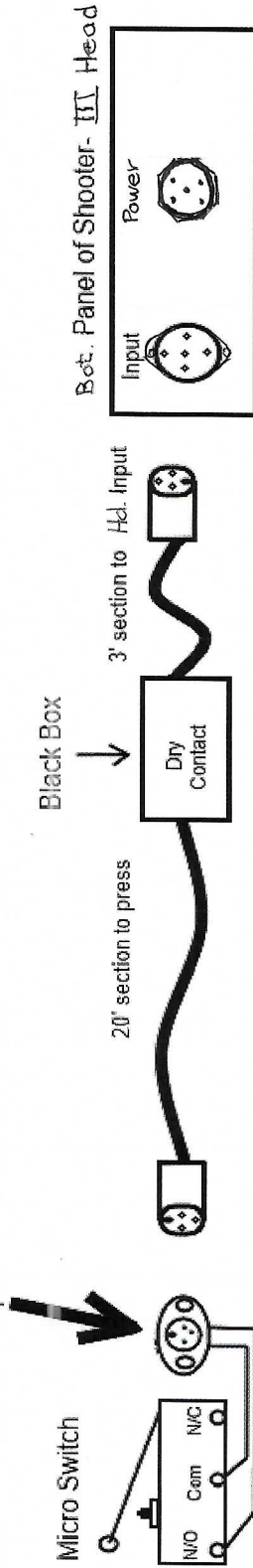

The "Dry Contact" Connection would be wired to a new or existing Micro Switch or any connection such as a relay with an open / close per sheet count no voltage connection.

NOTE: This is a "Dry" no voltage connection. Verify all connection prior to install. Failure to do so may result in damage to the Shooter-III and or your presses electronics.

DRAWING #13 -ELECTRONIC PICK-UP CONNECTION

Typical press connection using Electronic Coupling Pick up (E.C. Pick up)

TS-311

TS-311-B: E.C. Pick up adaptor "AKA Pigtail"
 Gets wired to your presses counter

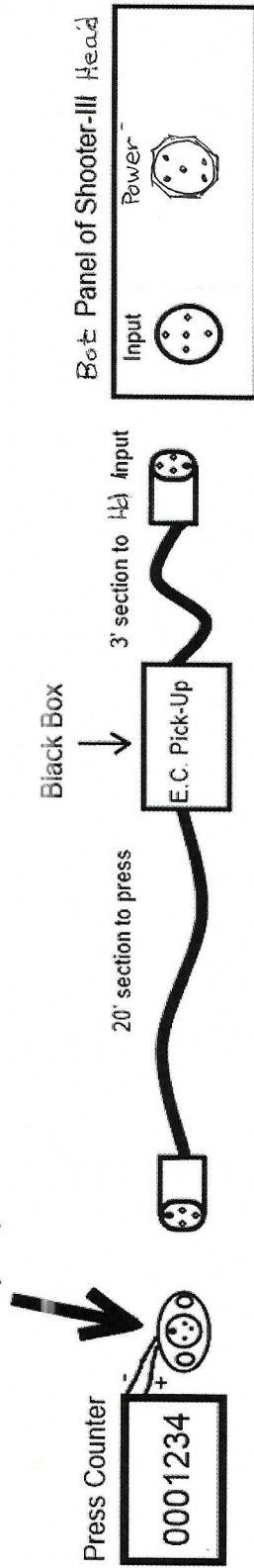

The E.C. Pick up adaptor would be wired in to the Presses Counter or Count pulse. This is a 2 wire connection that requires a high / low voltage pulse from 8V - 120V AC or DC per printed sheet.

DRAWING NO. 14 - WIRING SCHEMATIC

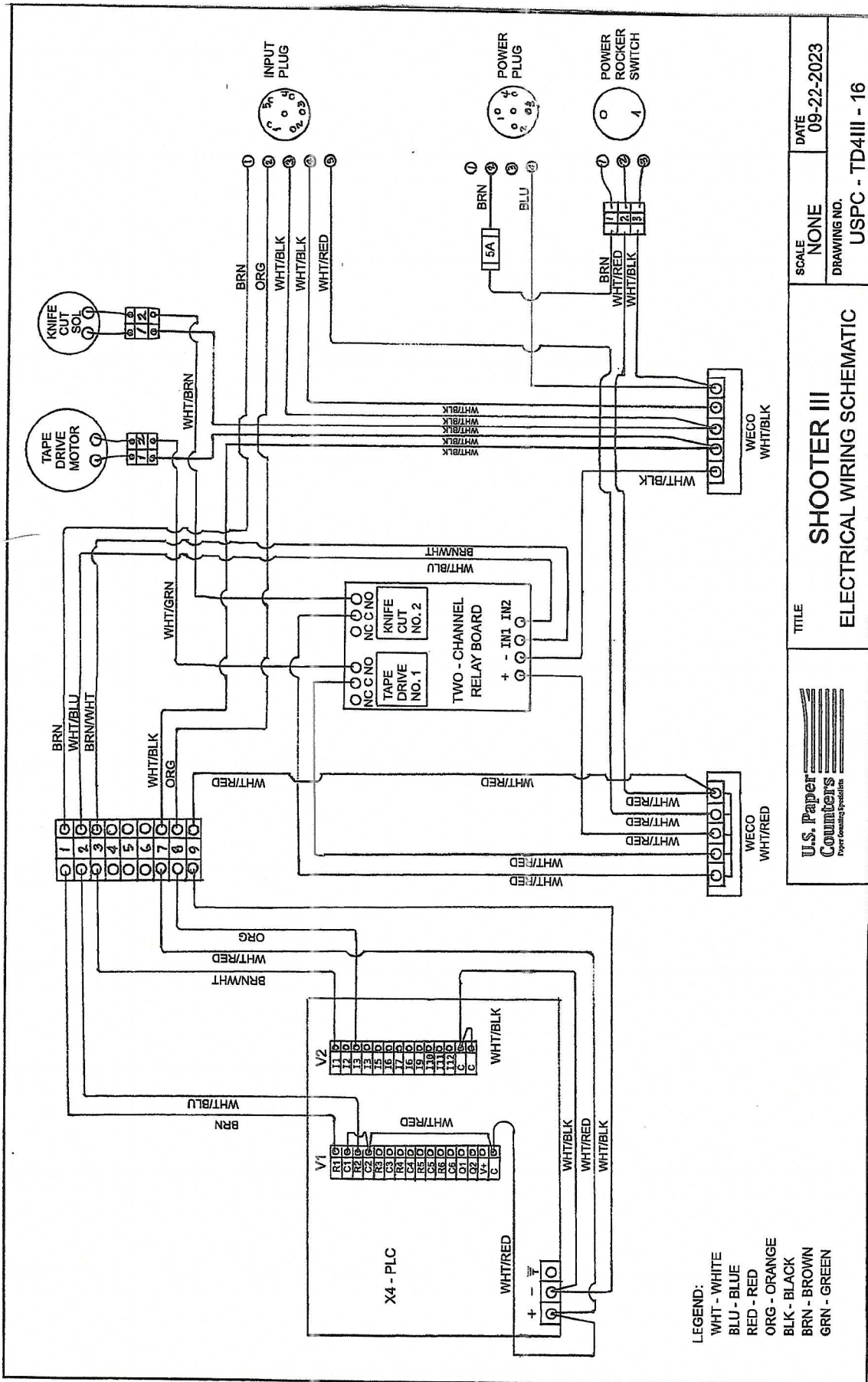

LEGEND:
 WHT - WHITE
 BLU - BLUE
 RED - RED
 ORG - ORANGE
 BLK - BLACK
 BRN - BROWN
 GRN - GREEN

U.S. Paper Counters <small>Paper Counters Specialists</small>	TITLE SHOOTER III ELECTRICAL WIRING SCHEMATIC	SCALE NONE	DATE 09-22-2023
		DRAWING NO. USPC - TD4III - 16	

***** FOR FASTER SERVICE, PLEASE USE PART NUMBERS**

WHEN PLACING ORDER!***

PHONE: (518) 622-2600

FAX: (518) 622-2695

E-MAIL: service@wecount.com

WEB SITE: www.wecount.com

MAILING ADDRESS: 138 ELIZABETH TERRACE, CAIRO, NY 12413

SHIPPING ADDRESS: 138 ELIZABETH TERRACE, CAIRO, NY 12413

Index

A	
Adjustments.....	17
Alignment of Loader Box.....	17
B	
Basic Adjustments & Maintenance	17
Brake Hub Assembly.....	22,23
Batch Size.....	15
D	
Drive Belt	18, 20, 21
Dry Contact EC Pick-Up Press Connection	7, 27
E	
Electrical Specifications	5
Electronic Couping Pick-Up.....	7, 28
H	
Head Mounting Bracket	14
I	
InsertTape, Loading.....	12
Installation.....	7
K	
Knife Assembly.....	18, 20
Knife Delay	15
L	
Loader Box.....	20
M	
Maintenance	18
Microswitch.....	27
O	
Operation.....	15
Optional 90 Deg. Tabbing head.....	5, 13
P	
Parts Lists	19
R	
Repair Authorization	GO TO WEBSITE: UNDER SERVICE SUPPORT
S	
Service.....	29
Shipping Specifications.....	5

Shooter III Operation.....	15
Solenoid.....	26
Stand Assembly.....	5, 7, 9
Swivel Mount Assembly.....	14

T

Tabbing Head or Shooter Head.....	7,11,12,13,14,20,24,26
Tape Chute Assembly.....	17,20
Tape Deflector.....	11,24,25
Tape Drive Belt.....	18, 20
Tape Hub Assembly.....	22
Tape Length Adjustment Plate.....	22
Tape Length.....	15
Tape Reel Cover Assembly.....	12
Technical Details.....	5

W

Web Site.....	29
Warranty.....	3

LIST OF DRAWINGS

#	DESCRIPTION	Page #
	Shooter Stand Assembly Dwg TS-200-III-2022	9
2	Tape Deflector	11
3	Loading Insert Tape (Roll of Tabbing Material)	12
4	90° Tabbing Head	13
5	Swivel Mount Assembly	14
7	Tabbing Head & List of Parts	20,21
8	Brake Hub Assembly	22
9	Tabbing Head w/Deflector, Tape Reel Cover Assy.	24
10	Shooter III Internal Components	26
12	Dry Contact EC Pick-Up Press Connection	27
13	Electronic Pick-Up Connection	28
14	Wiring Schematic	29